

Note: Ensure steel work is suitably lined, levelled and within tolerance.  
 Panels are manufactured to suit a left to right direction of lay.  
 Gun-grade sealant type - non-setting butyl sealant.

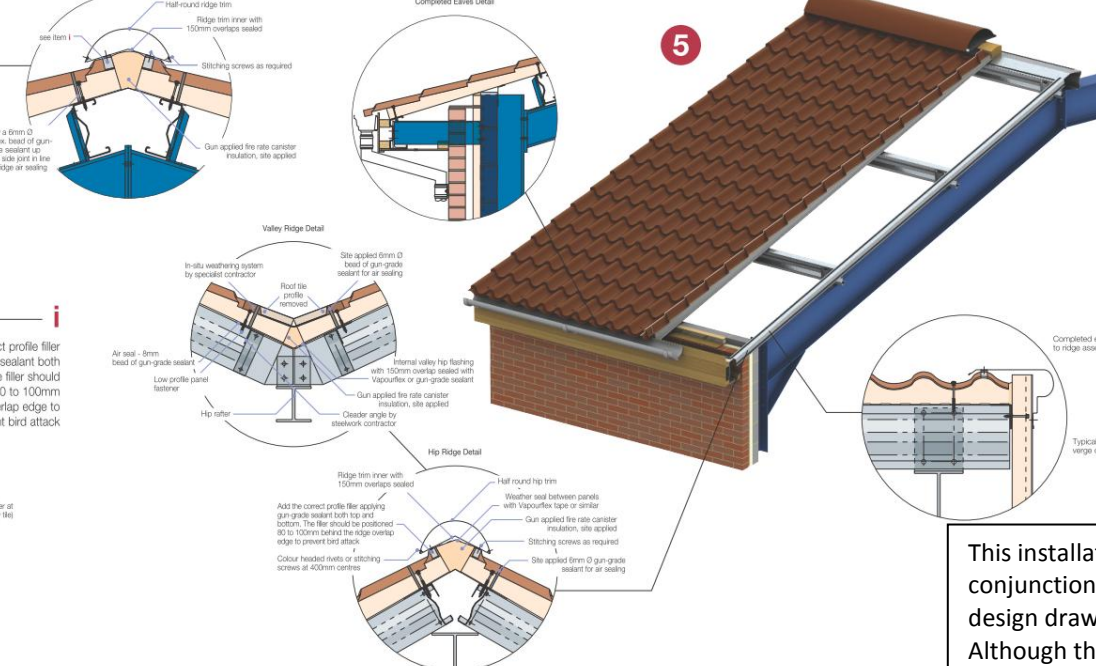
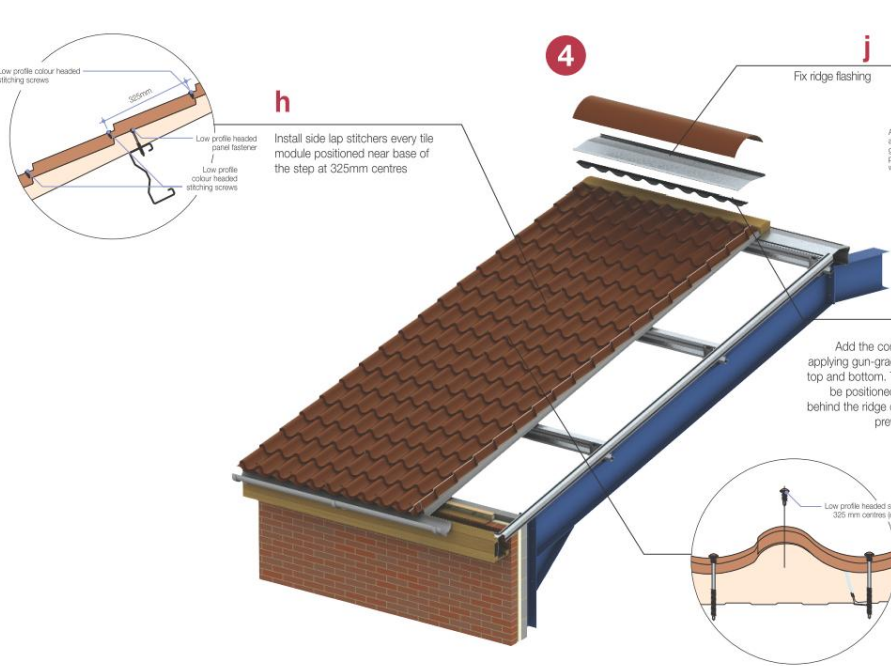
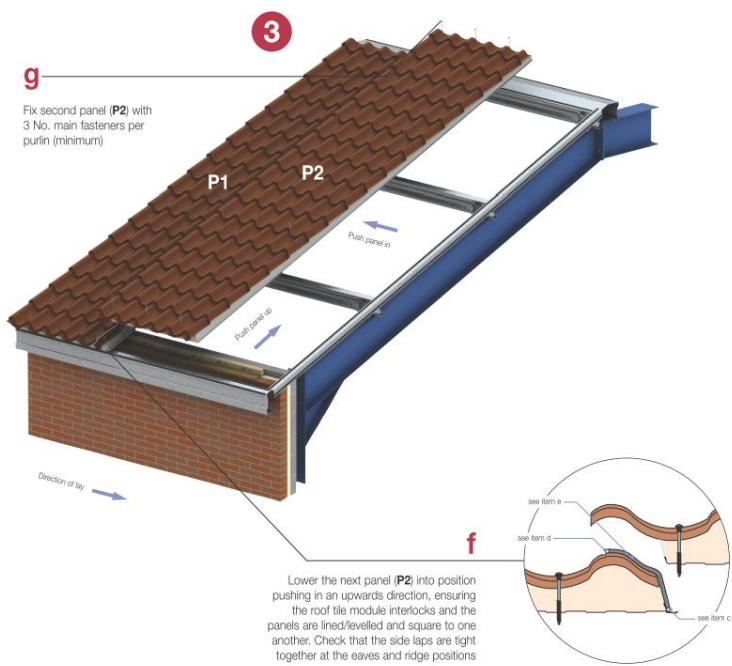
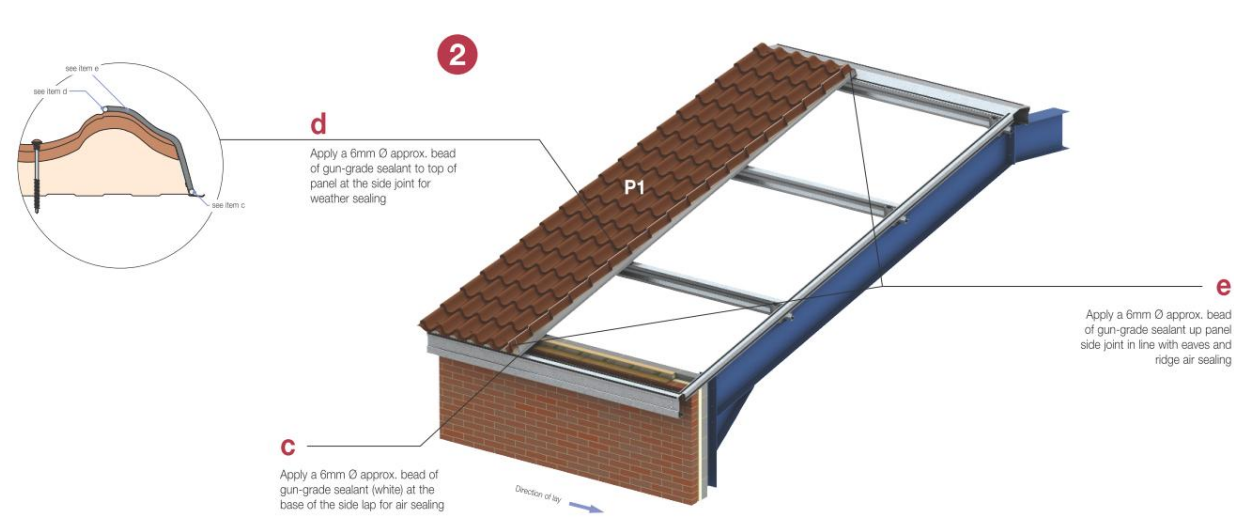
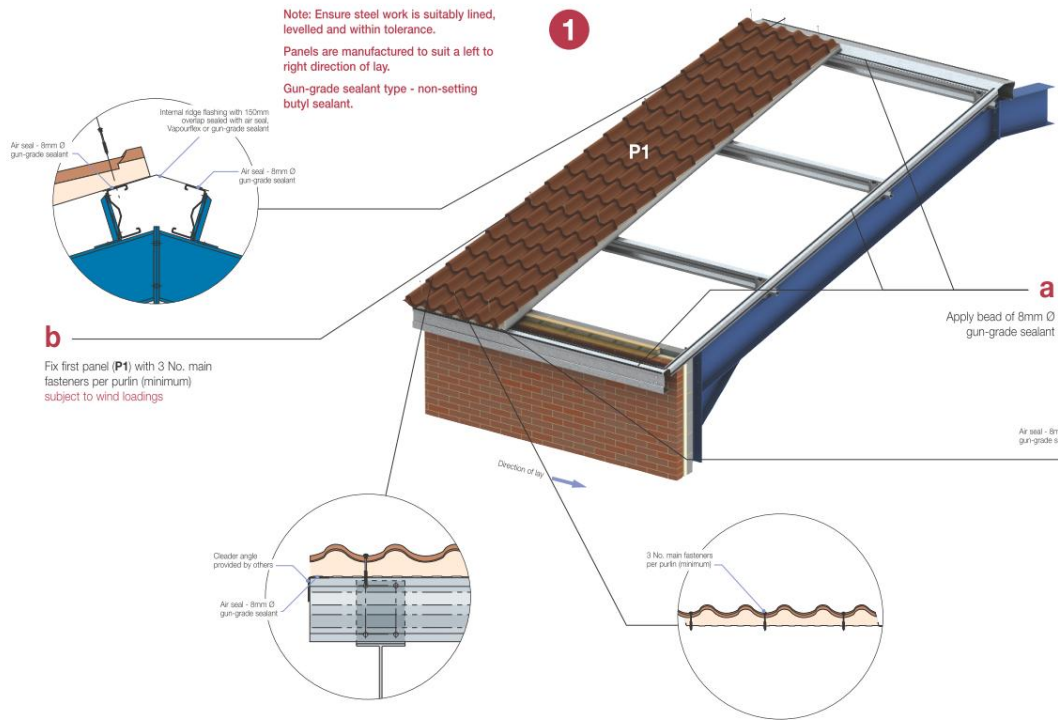

- Components**
- Primary/Main Fastener
  - Fire-rated Canister Insulation
  - Secondary/ Stitching Screws
  - Gun-Grade Sealant
  - Profilled Verge Filler
  - Hip Reticulated Foam Filler
  - Profilled Ridge Filler

This installation guide should be read in conjunction with the 'project specific' design drawings and method statements. Although this 'installation guide' is deemed to be correct at the time of publication, We reserve the right to amend the information at any time in the future.